

# ES Series

IEC-320 C14 Inlet Power Entry Module



NRTL/C  
CSA NRTL File No. 110265  
TUV File No. E9672914



## Applications

The ES Series offers Snap-in or Flange Mount modules for general purpose applications where line-to-line & line-to-ground noise must be controlled. This series is offered with a 1, 3, 6 or 10 amp rating.

All of the above series provide an IEC connector, single or double fuses and 2-pole power ON/OFF switch.

## Electrical Schematic

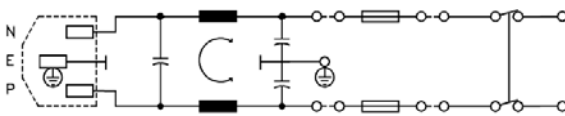

## How to define a part number:

**ES**

Series

**S**

S=Snap-In  
F=Flange

**1**

Fusing  
1=Single  
2=Dual

-

**1**

Current  
Rating

## Specifications

**Voltage rating:** 115/250 VAC

**Line frequency:** 50/60 Hz

**Leakage current:** 0.25 mA maximum at 115 V, 60 Hz  
(line-to-ground) 0.50 mA maximum at 250 V, 50 Hz

**Test voltage:** Line to ground, 2250 VDC  
Line to line, 1450 VDC

## Common Mode

Current Rating	Frequency (MHz)						
	.15	.5	1	3	5	10	30
1 A	14	17	24	35	40	30	25 (db)
3 A	8	15	18	30	32	38	30 (db)
6 A	6	12	17	25	31	35	20 (db)
10 A	2	5	10	20	28	30	15 (db)

## Differential Mode

Current Rating	Frequency (MHz)						
	.15	.5	1	3	5	10	30
1 A	2	10	15	23	30	40	45 (db)
3 A	2	10	15	23	26	45	47 (db)
6 A	4	12	20	25	25	40	45 (db)
10 A	1	5	15	20	25	30	40 (db)

Minimum Insertion loss in 50 ohm system per MIL-STD-220A

# ES Series

## Ordering Information

Current Rating	Part Number	Dimensions (mm)			
		A	B	C	D
1A	ESS1-1	38.86	54.10	27.94	32.00
	ESF1-1	38.86	54.10	27.94	39.88
	ESS2-1	38.86	54.10	27.94	32.00
	ESF2-1	38.86	54.10	27.94	39.88
3A	ESS1-3	38.86	54.10	27.94	32.00
	ESF1-3	38.86	54.10	27.94	39.88
	ESS2-3	38.86	54.10	27.94	32.00
	ESF2-3	38.86	54.10	27.94	39.88
6A	ESS1-6	38.86	54.10	27.94	32.00
	ESF1-6	38.86	54.10	27.94	39.88
	ESS2-6	38.86	54.10	27.94	32.00
	ESF2-6	38.86	54.10	27.94	39.88
10A	ESS1-10	38.86	54.10	27.94	32.00
	ESF1-10	38.86	54.10	27.94	39.88
	ESS2-10	38.86	54.10	27.94	32.00
	ESF2-10	38.86	54.10	27.94	39.88

Connections are 0.250 Tab Terminals which extend 14.73mm.  
Mounting Hole Diameters on ESF Models are 4.78mm

### ESS Models:

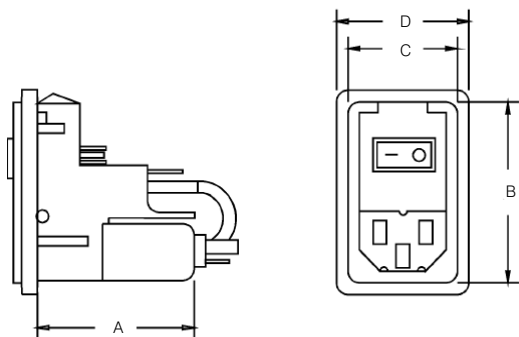

### Panel Cut-Out:

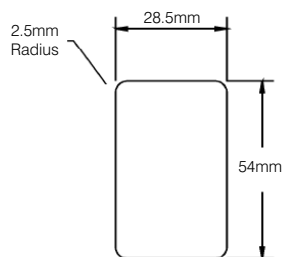

### ESF Models:

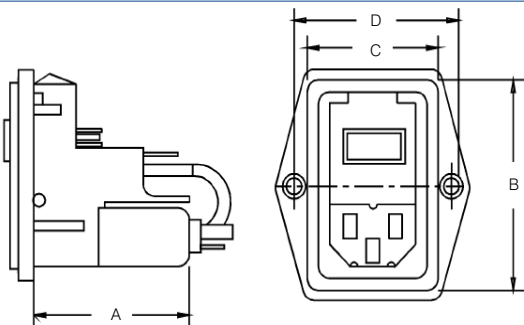

### Panel Cut-Out:

